

GORILLA SPORTS

Elliptical Bike (10000528)

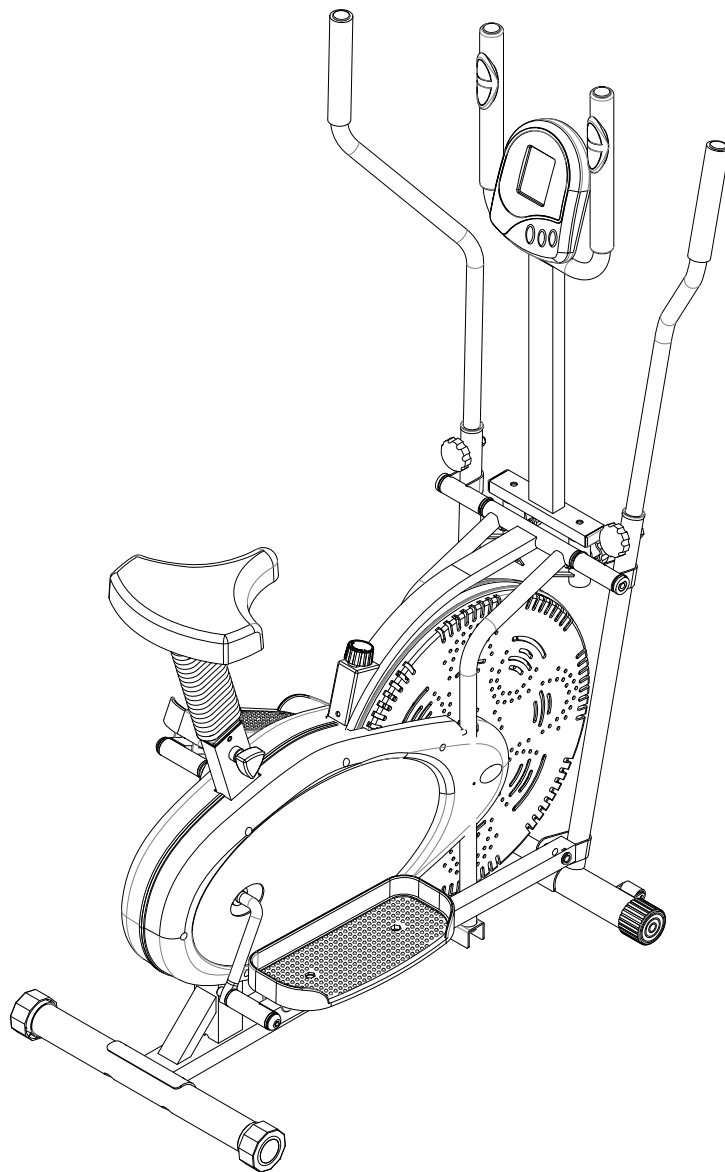



GORILLA SPORTS

Bolt for Right Crank : ($\varnothing 16 \times 89 \times L23$)

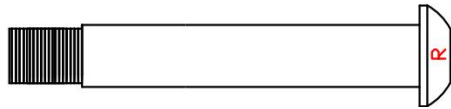

1X

Bolt for Left Crank : ($\varnothing 16 \times 89 \times L23$)

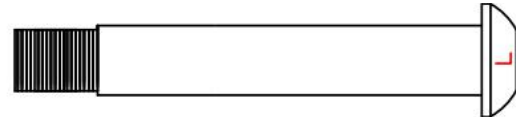

1X

Bolt : (M10*45)



4X

Bolt : (M10*56)

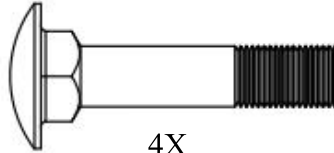

4X

Bolt : (M10*20)

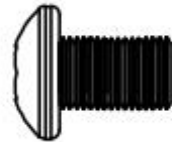

2X

Rotation Rod : ($\varnothing 15.8 \times 376$)



1X

Cap Nut: (M10)



4X

Curve Washer : ($\varnothing 10$)

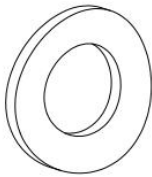

4X

Washer : ($\varnothing 28 \times \varnothing 16$)

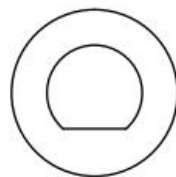

2X

Washer : ($\varnothing 16$)



4X

Bolt : (M10)

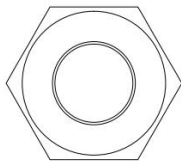

4X

Nylon Nut for left Crank : (B0.5*20)

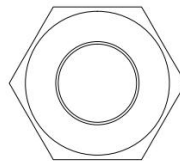

1X

Nylon Nut for right Crank : (B0.5*20)

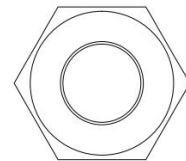

1X



GORILLA SPORTS

Spring Washer : (Ø13)



2X

Spring Washer : (Ø11.5)

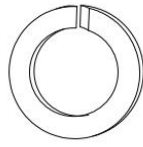

2X

Spring Washer : (Ø10)

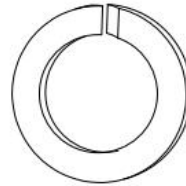

2X

Bolt : (M10*30)

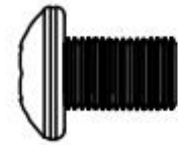

2X

S13 Nut Cap

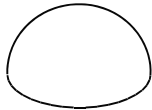

2X

S17 Nut Cap

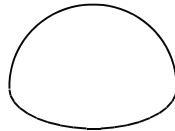

2X

S19 Nut Cap

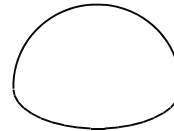

2X

Washer : (Ø8)

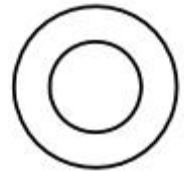

2X

Seat Height Adjustment
Knob: (M12)

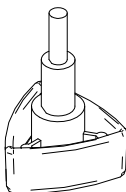

1X

Handrail Arm Height
Adjustment Knob: (M8*36)

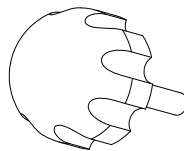

1X

Multi Hex Tool
S10-S13-S17-S19

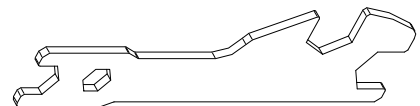

1X



GORILLA SPORTS

Allen Wrench S6



2X

Allen Wrench S8



1X

Multi Hex Tool with Phillips
Screwdriver S13-S14-S15

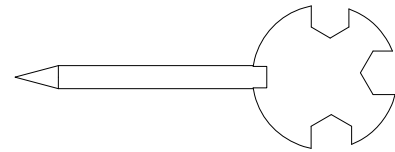

1X



GORILLA SPORTS

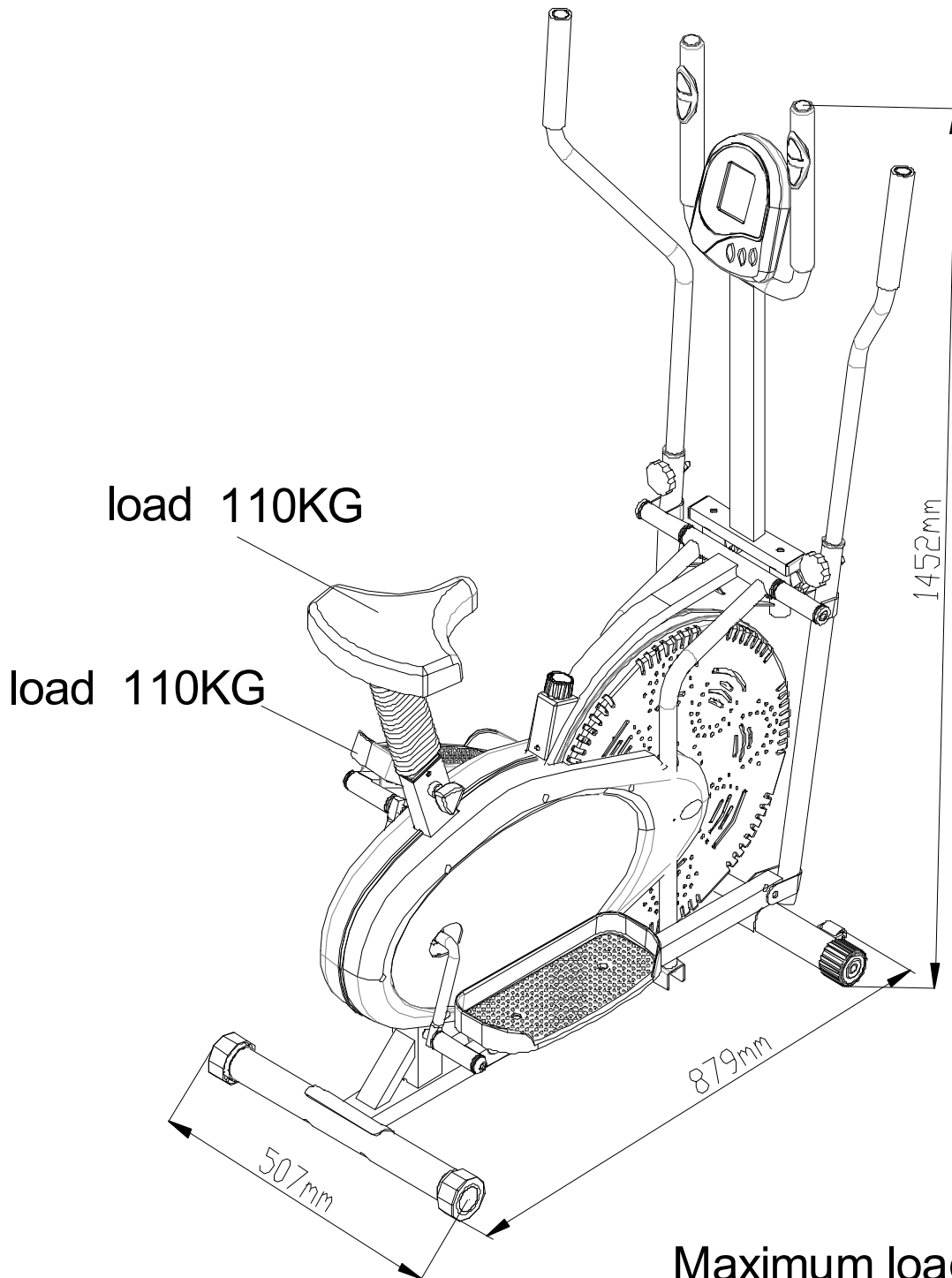





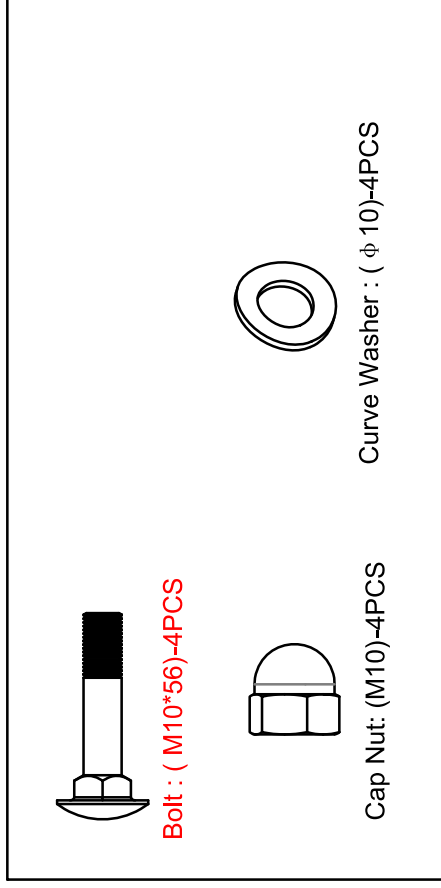
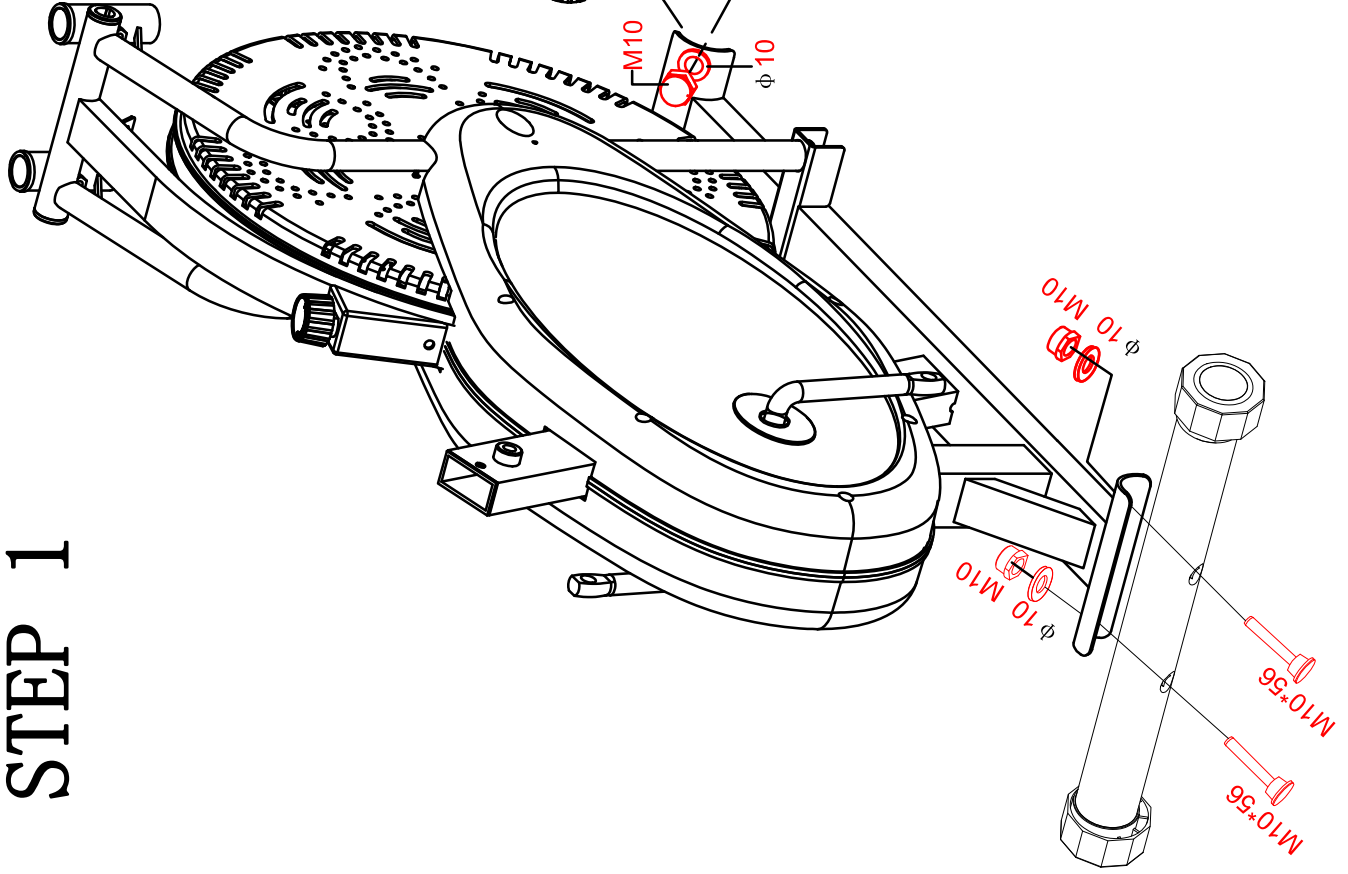



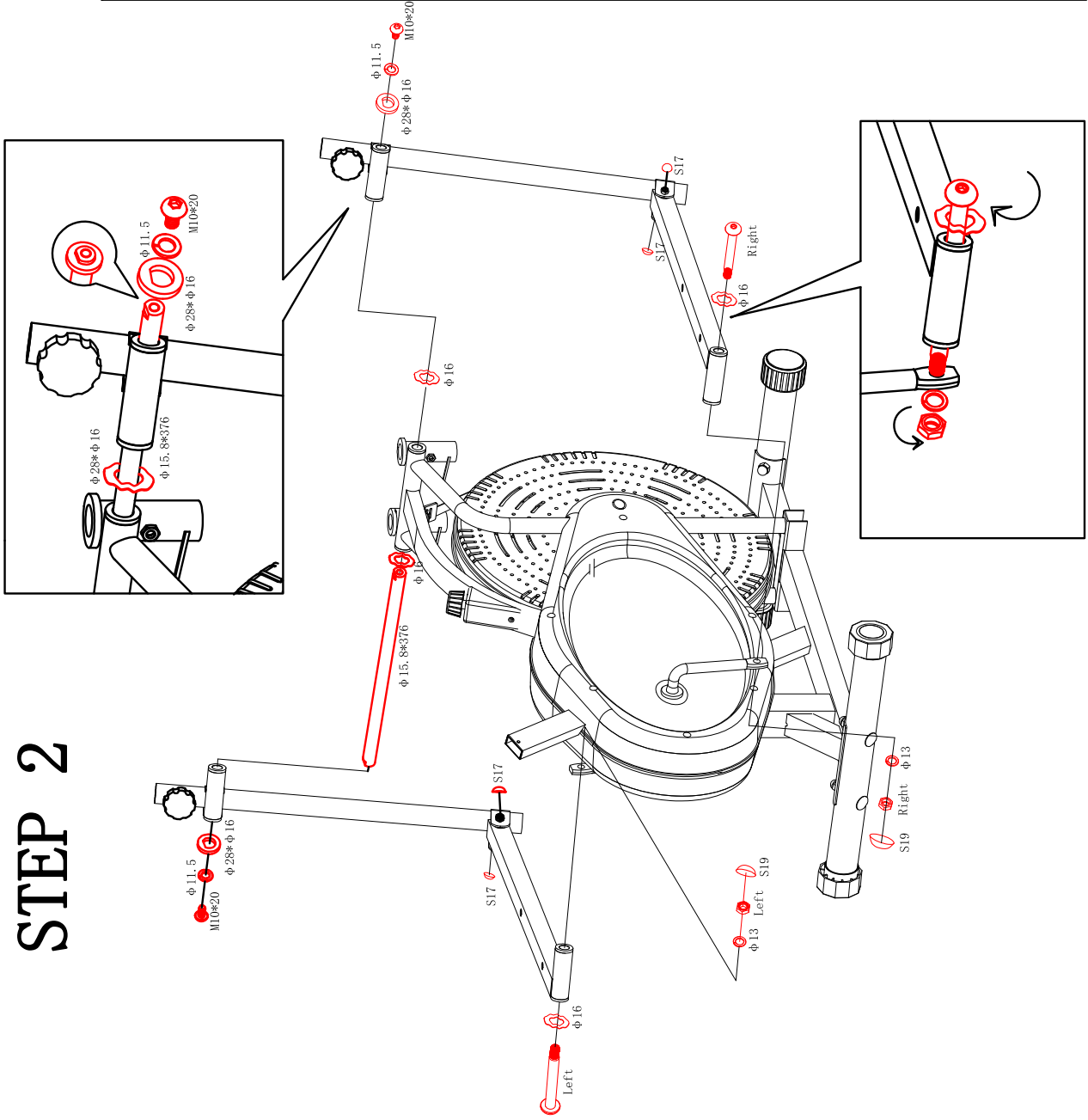



Maximum load 110KG

STEP 1

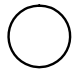
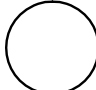

STEP 2



	Rotation Rod : (φ 15.8*376)		Washer : (φ 28* φ 16)-2PCS		Spring Washer : (φ 13)-2PCS
	Bolt for Right Crank : (φ 16*89*L23)-1PC		Bolt for Left Crank : (φ 16*89*L23)-1PC		Nylon Nut for left Crank : (B0.5*20)-1PC
	Nylon Nut for Right Crank : (B0.5*20)-1PC		S17 Nut Cap -4PCS		S19 Nut Cap -2PCS
	Bolt : (M10*20)-2PCS		Washer : (φ 16)-4PCS		Spring Washer : (φ 11.5)-2PCS

STEP 3

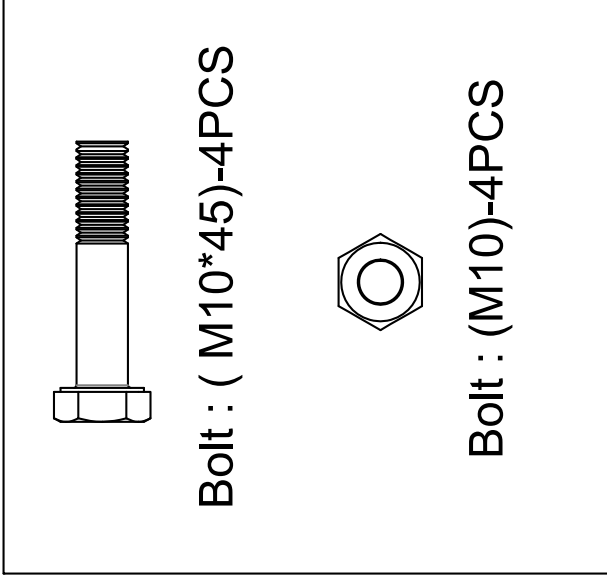
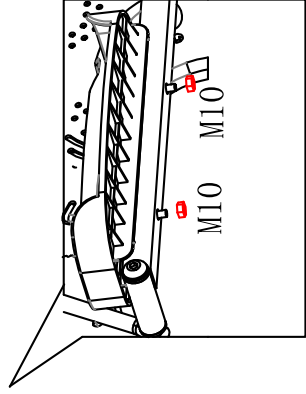
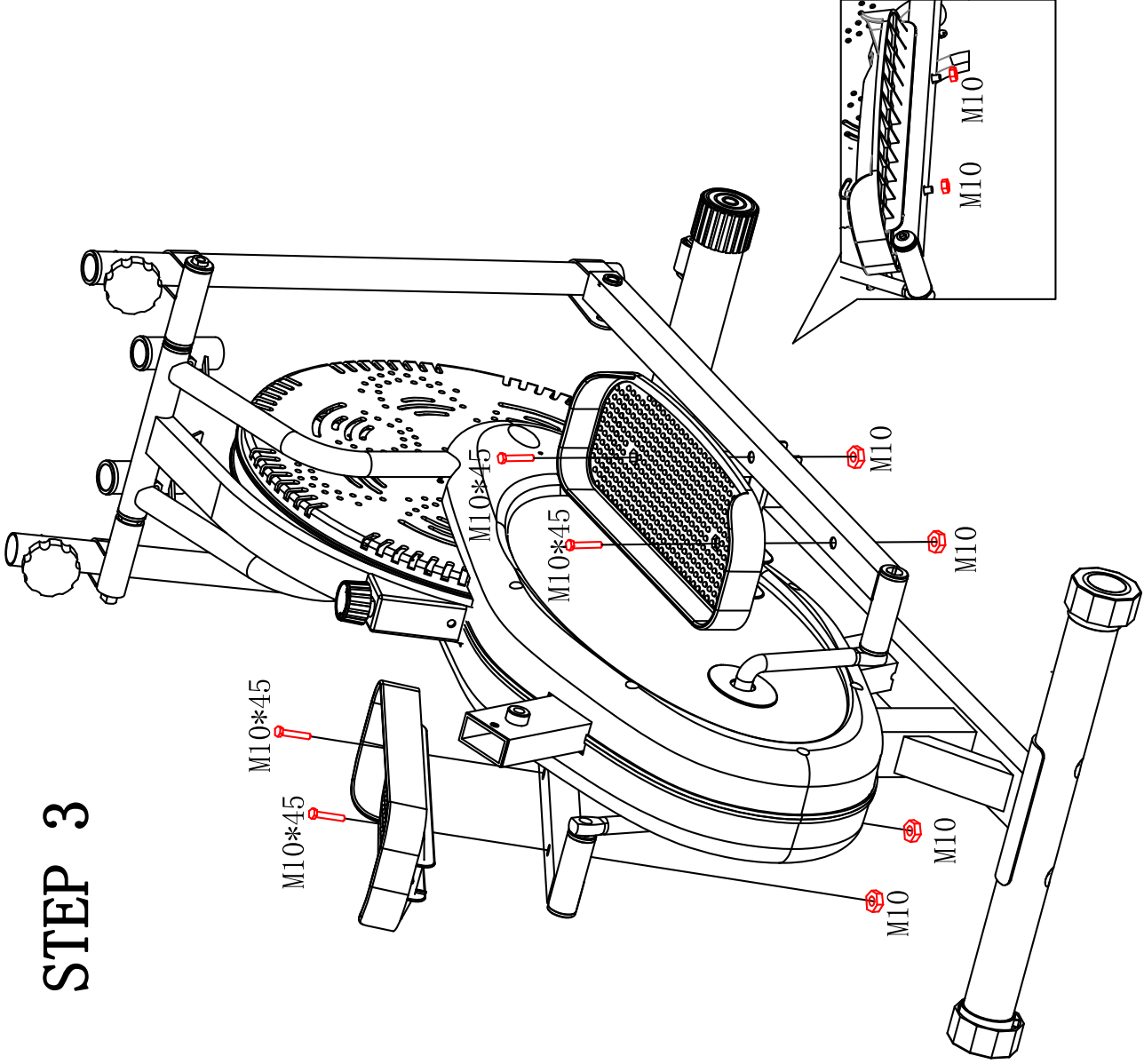

STEP 4

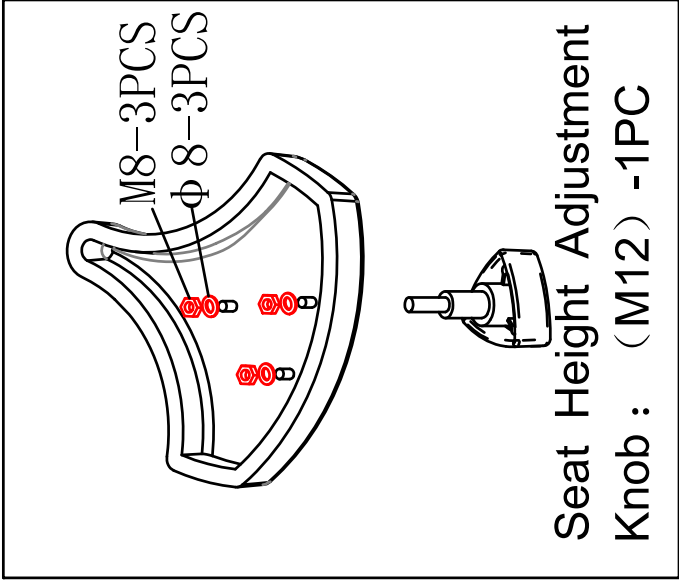
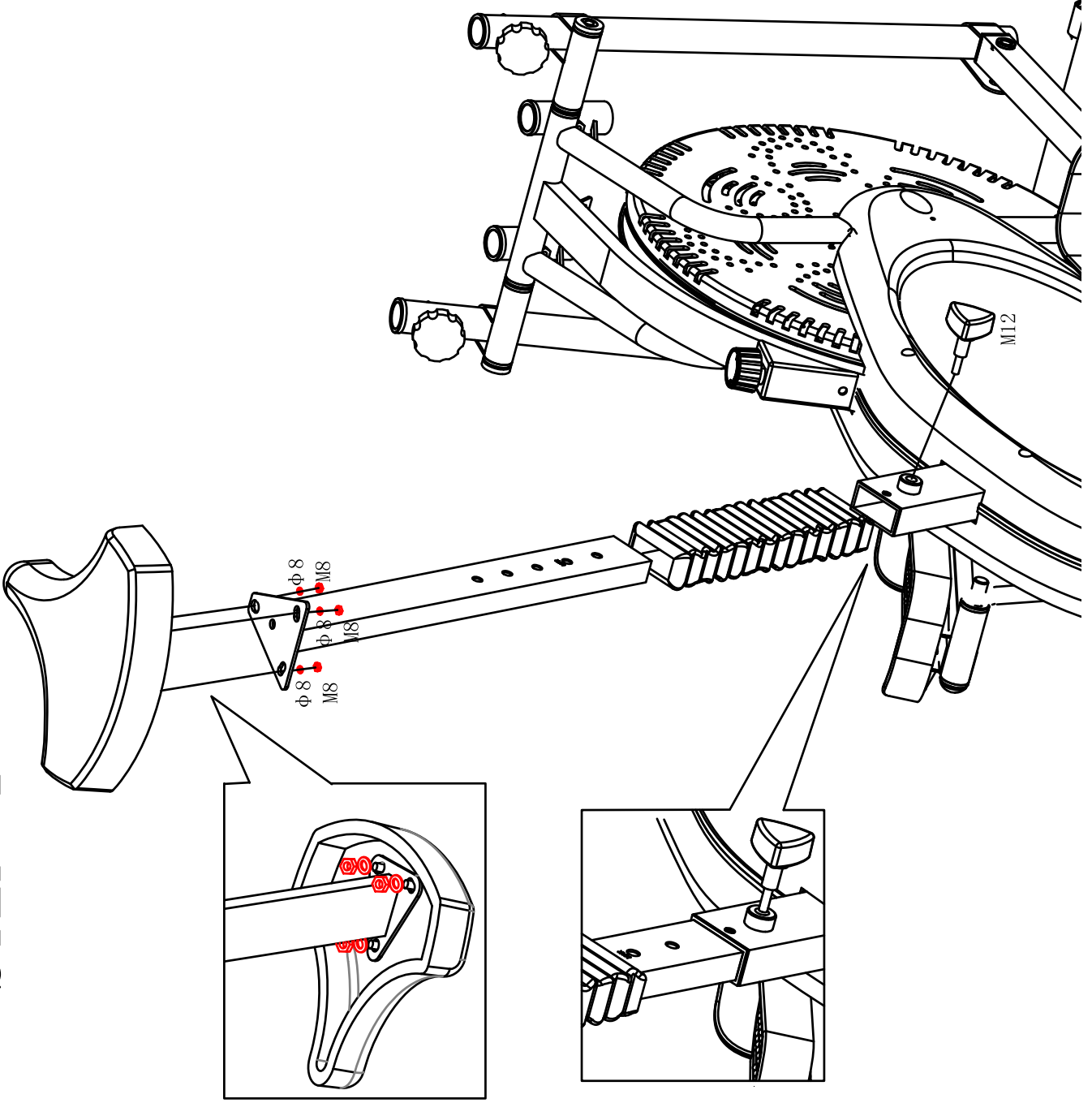

STEP 5

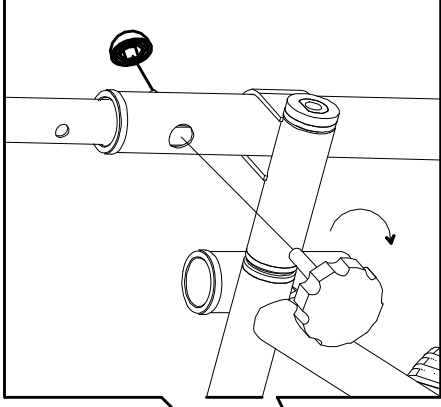
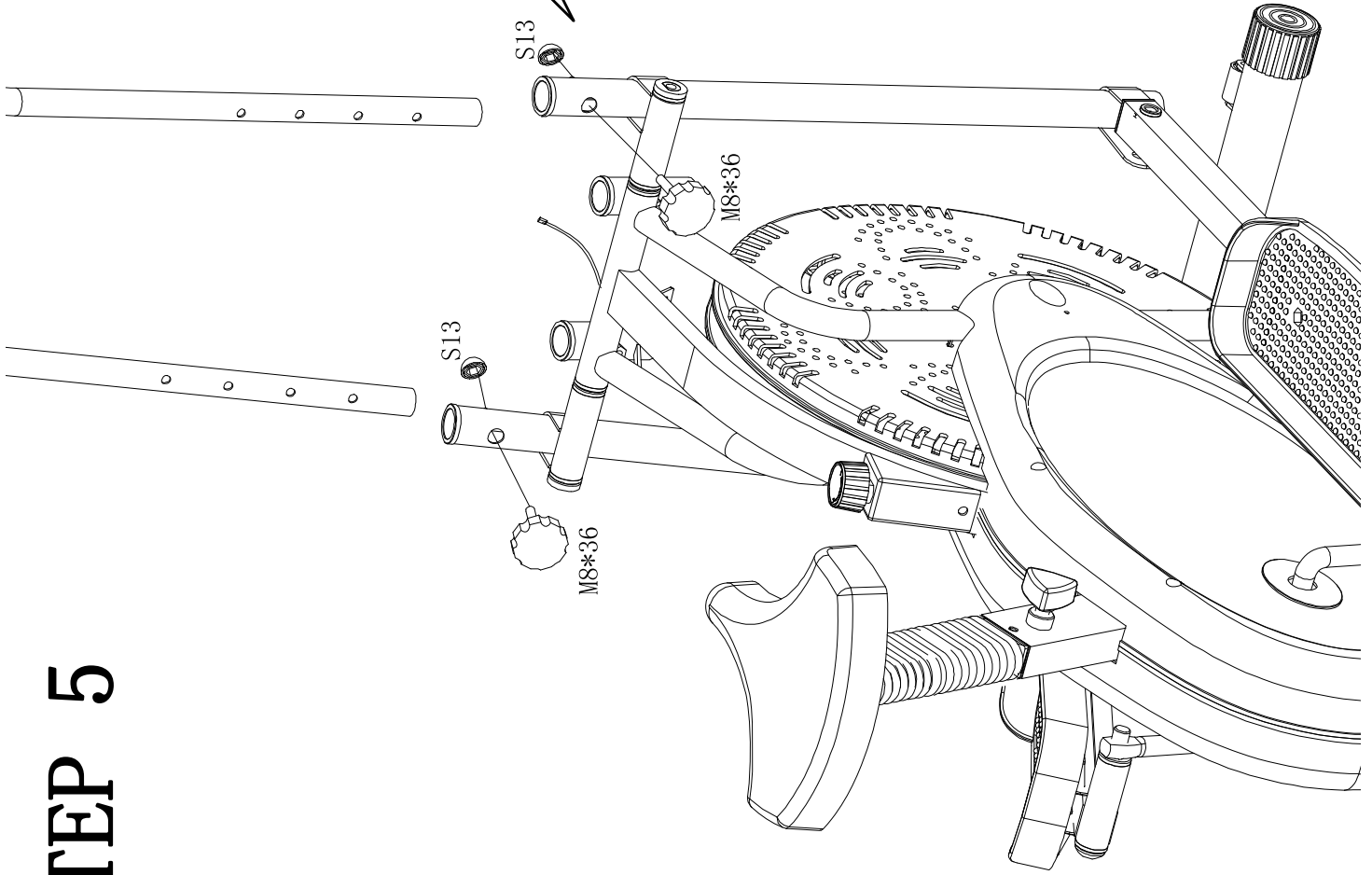

Handrail Arm
Height Adjustment
Knob: (M8*36) -2PCS



S13 Nut Cap -2PCS

STEP 6

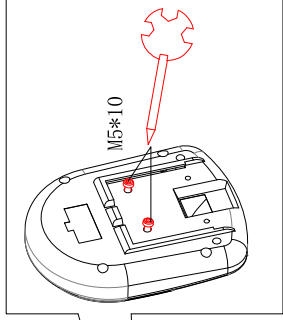
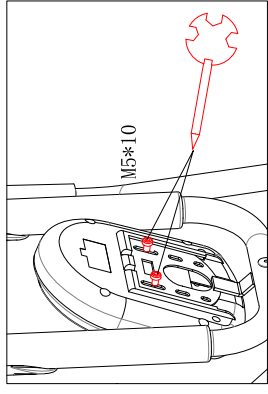
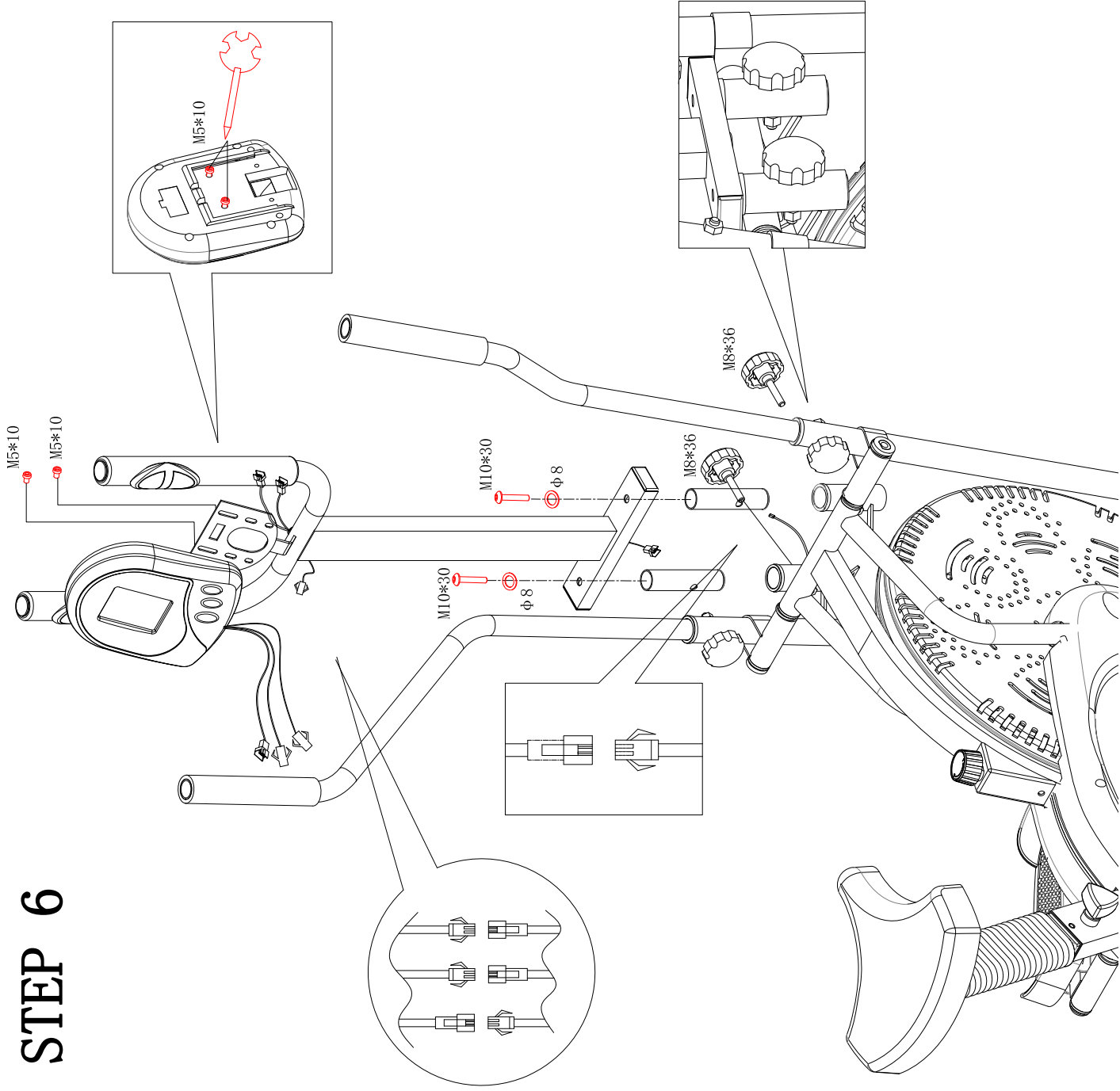

Bolt : (M10*30)-2PCS

Washer: (φ 8) -2PCS

Handrail Arm Height Adjustment Knob: (M8*36) -2PCS